



Property type : Villa

Location : Sucina

Bedrooms : 3

Bathrooms : 2

Swimming pool : Private

Garden : Private

Built surface : 111 m²

Plot surface : 211 m²

✓ Solarium

✓ Pre-air conditioning

NEW BUILD SEMI-DETACHED VILLAS IN SUCINA

New Build contemporary style semi-detached villas with a pure and elegant design, with a distribution oriented to the Mediterranean light that invades the entire interior of the house. With open day areas in which the kitchen joins the living room, creating a contiguous environment delimited by a central island, an incredible area to enjoy breakfast or a meal every day.

The living-dining room joins the porch and the pool terrace, creating a single space.

This villa has 3 bedrooms, 2 bathrooms and a charming outdoor toilet to service the pool area. The master bedroom is very bright, with en suite bathroom, dressing room and direct access to the main terrace of the house, where the pool is located.

The incredible solarium at the top of the house, make it unique and ideal to enjoy the sun all year round.

A current project, stylish and built with qualities at the height of its design, which gives us a unique opportunity for an excellent quality of life, with open spaces and fresh air.

Sucina is a typical Spanish village just a few kilometres from the beaches of the Costa Calida and the Mar Menor. In recent years there has been extensive development as the popularity of this beautiful village has grown. Murcia Airport is only 25 km away, and via the AP-7 freeway, Pista Mediterraneo, Alicante airport is only 45 minutes away. Although small, the village facilities have grown to meet the needs of a growing population and where the artisan trade is still alive and well.

If you are a golf lover, here you have a wide selection of golf courses in the area, the nearest being only 4km away.



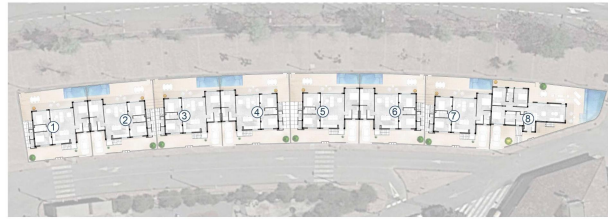

SUPERFICIE DE PARCELAS

PARCELA VIVIENDA 01	214.67 m ²
PARCELA VIVIENDA 02	218.90 m ²
PARCELA VIVIENDA 03	210.20 m ²
PARCELA VIVIENDA 04	225.91 m ²
PARCELA VIVIENDA 05	222.25 m ²
PARCELA VIVIENDA 06	212.25 m ²
PARCELA VIVIENDA 07	211.71 m ²
PARCELA VIVIENDA 08	228.64 m ²
TOTAL	1.792.41 m²

